

ISO-6432 DSN Standard Stainless Steel Cylinder

DSN Stainless Steel Cylinder



Ordering Code

- DSN** - **20 X 50 - S**
- DSN** - Double Acting Cylinder
 - DSND** - Double Acting Thru Rod Cylinder
 - U** - Flat End Mounting
 - Blank** - Standard Mounting
 - C** - With cushioning
 - Blank** - Without cushioning
 - 20** - Bore Diameter (mm)
 - 50** - Stroke (mm)
 - S** - Magnetic Piston
 - Blank** - Non-Magnetic Piston

DSN Pneumatic Cylinder head, piston and barrel made of aluminum alloy; piston rod made of chromed plated high carbon steel; seals are made of NBR for standard working temperature; for higher working temperature seals are made of viton and teflon.

With Cushioning

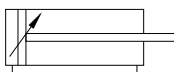

W/ Cushioning & Magnet

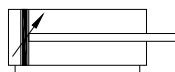

Thru Rod w/ Cushioning

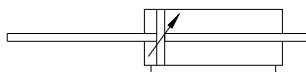

Thru Rod w/ Cushioning & Magnet

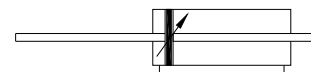

Bore	Standard Stroke														Max. Stroke		
	25	50	75	80	100	125	150	160	175	200	-	-					
12	25	50	75	80	100	125	150	160	175	200	-	-					300
16	25	50	75	80	100	125	150	160	175	200	-	-					300
20	25	50	75	80	100	125	150	160	175	200	250	300					500
25	25	50	75	80	100	125	150	160	175	200	250	300	350	400	450	500	500
32	25	50	75	80	100	125	150	160	175	200	250	300	350	400	450	500	500
40	25	50	75	80	100	125	150	160	175	200	250	300	350	400	450	500	500

Bore	12	16	20	25	32	40
Type	Double Acting / Single Acting					
Working Medium	Air					
Working Pressure Kg/cm ²	1~9.0					
Maximum Pressure Kg/cm ²	13.5					
Working Pressrue °C	0~70					
Speed mm/s	50~800					
Cushioning	Without			With Cushion Adjustment		
Port Size	M05 x 0.8			G 1/8"		

DSN Series Reed Switch and Holder



Dimension

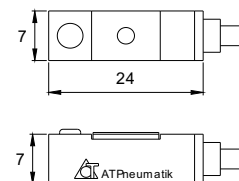

AL-03 Magnetic Switch

BK Magnetic Switch Holder
16 to 40mm bore diameter cylinder

Reed Switch Specification						
Model	Output	Current	Response	Indicator	Wire	
AL-03-R	Contact	5-240Vac	5-60mA	1msec max.	LED	2M
		5-110Vdc				
AL-03-NPN	NPN	5-30Vdc				
AL-03-PNP	PNP					

Dimensions are in mm

DSN Series ISO-6432 Double Acting cylinder

DSN 12~16 Double Acting Cylinder

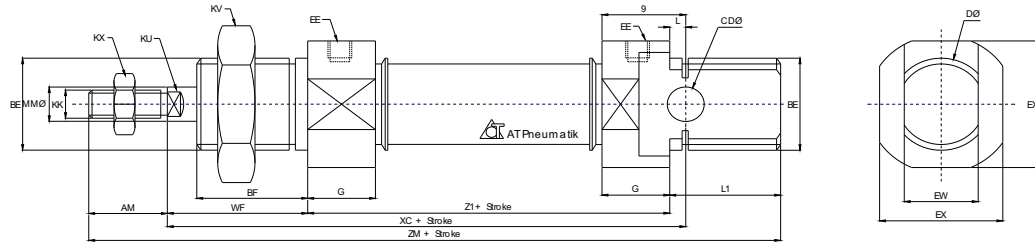

DSN 20~40 Double Acting Cylinder

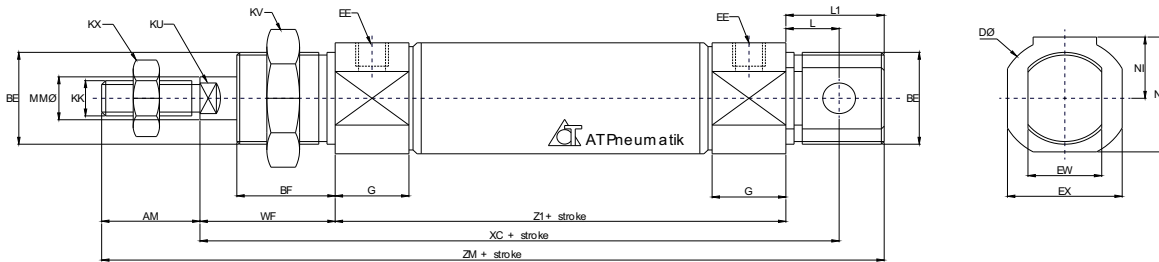

DSNU 20~40 Double Acting Cylinder

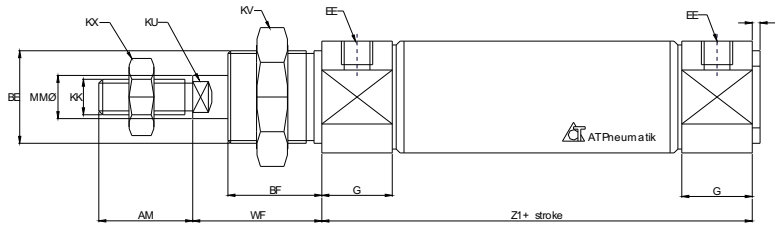

DSND 20~40 Double Acting Cylinder

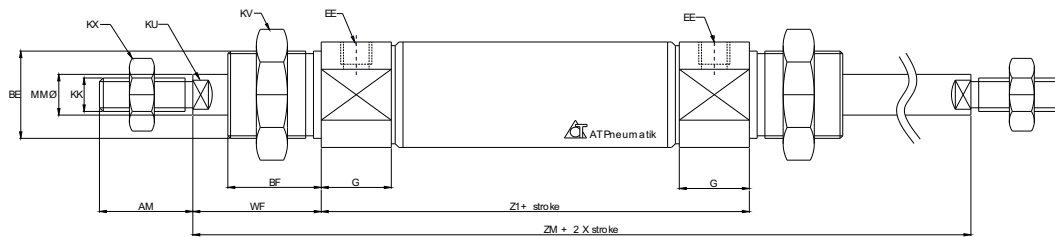

DSN Dimension

Bore Diameter	AM	BE	BF	CD	D	EE	EX	EW	G	KK	KU	KV	KX	L	L1	MM	NI	NJ	WF	XC	Z1	ZB	ZM
12	16	M16 X 1.5	16	6	21	M05	19	12	10	M06 X 1.0	5	24	12	4	16	6	-	-	22	77	51	105	95
16	16	M16 X 1.5	16	6	21	M05	19	12	10	M06 X 1.0	5	24	12	9	16	6	-	-	22	82	51	105	102
20	20	M22 X 1.5	18	8	30	G 1/8"	27	16	15	M08 X 1.25	7	27	14	12	22	8	15	28.5	24	95	59	125	107
25	22	M22 X 1.5	20	8	30	G 1/8"	27	16	16	M10 X 1.25	9	27	17	12	22	10	15	28.5	28	104	64	136	120
32	23	M27 X 2.0	20	10	38	G 1/8"	35	20	16	M10 X 1.25	10	35	17	15	27	12	19	36.5	28	115	72	150	128
40	23	M33 X 2.0	20	10	40	G 1/8"	42	20	16	M14 X 1.5	14	41	22	15	27	16	22.5	43.5	28	115	72	150	128

Dimensions are in mm